

Landenstown Bridge

TOWN

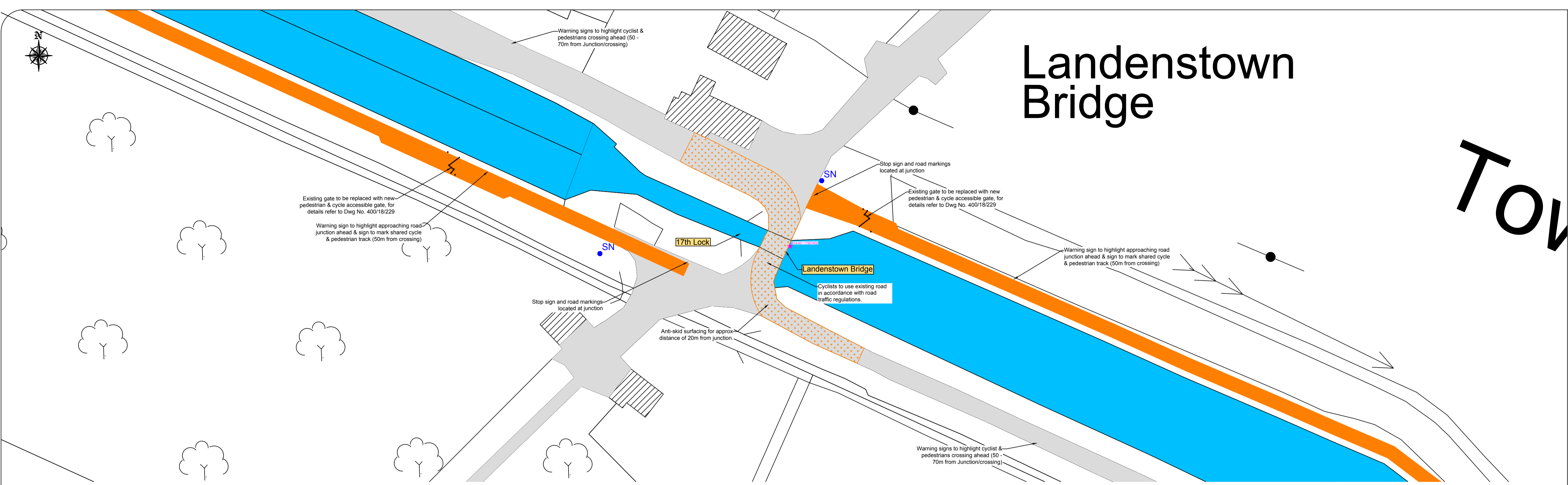

Detail 4 - Detail at Landenstown Bridge and Lock

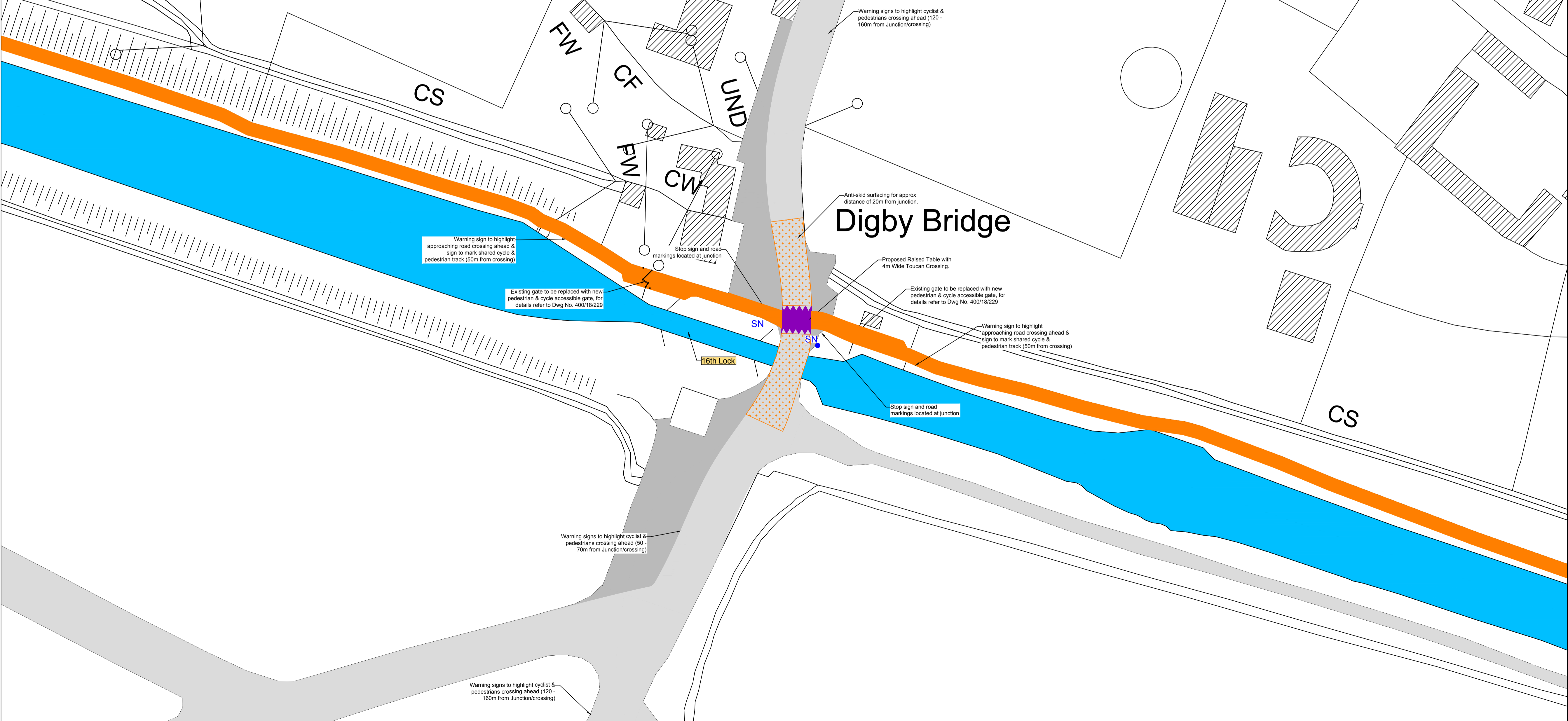

Detail 5 - Detail at Digby Bridge and Lock

- LEGEND:**
- SN Site Notice for Part 8
 - ▨ Existing Public Road
 - ▨ Existing Houses
 - Existing Field Entrance
 - Existing Overbridge
 - Existing Underbridge (Aqueduct)
 - Existing Canal
 - Existing Green Area
 - Existing Footpath / Paved Areas
 - ▨ Existing Canal / Pedestrian Bridges
 - ▨ Existing Pedestrian Crossing
 - Existing Residential Access
 - Existing Farm Yard Access
 - ▨ Special Area of Conservation
 - ▨ Natural Heritage Area
 - Existing Waterways Ireland Lock Gate
 - Existing Waterways Ireland Gate to be replaced with new (controlled access)
 - Proposed New Gate (controlled access)
 - Proposed New Cyclepath 3.0m Wide - Surface Types to be Decided
 - Proposed New Cyclepath / Shared Surface
 - Existing Cyclepath
 - Existing Part 8
 - ▲ National Monuments
 - ★ Protected Structure / NIAH

© Ordnance Survey Ireland. All rights reserved.
Licence No.: 2004/07CCMA (Kildare County Council)

DESCRIPTION:	DATE	INT	REV

Kildare County Council
Planning Department
Áras Chill Dara,
Devoy Park, Naas,
Co Kildare.

PROJECT:
Proposed Grand Canal
Cycle Route

TITLE:
Road Crossing Detail 4 & 5
Landenstown & Digby Bridge

SCALE: 1:500	PROJECT NO: GCP8CR	DRAWING NO: 400/18/224
DATE: June 2018	DRAWN BY: EM	CHECKED: -